

LINE	BEARING	DISTANCE
L1	S35°46'09"E	25.00
L2	N00°06'57"E	1.81
L3	N89°48'35"W	40.77
L4	N00°21'59"W	10.48
L5	S01°30'00"E	107.08
L6	S89°44'00"E	40.18
L7	N88°15'00"E	35.83
L8	S59°25'00"E	127.95
L9	S34°15'00"E	90.35
L10	N00°00'07"W	259.65
L11	N90°00'00"E	5.00
L12	S00°00'00"E	259.95
L13	S86°33'06"E	5.00
L14	S87°59'40"E	130.63
L15	N60°00'00"E	9.75
L16	N00°00'13"E	98.65
L17	S00°00'00"E	100.00
L18	S35°46'09"E	39.30

CURVE	LENGTH	RADIUS	DELTA
C1	62.36'	600.00'	5°57'16"
C2	297.01'	415.00'	41°00'22"
C3	556.09'	415.00'	76°46'31"

## RECORD OF SURVEY

A PORTION OF THE NW 1/4 OF SECTION 34,  
 TOWNSHIP 18 NORTH, RANGE 18 EAST, W.M.  
 KITTITAS COUNTY, WASHINGTON

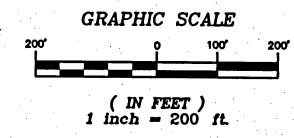

- NOTES:**
1. THE PURPOSE OF THIS SURVEY IS TO IDENTIFY AND MARK THE EXTERIOR BOUNDARY LINES FOR LOTS 4, 5, 6 AND 7 AND ADJUST THE BOUNDARIES OF SAID LOTS TO THE CONFIGURATION SHOWN HEREON.
  2. THIS SURVEY WAS PERFORMED USING A TRIMBLE S6 TOTAL STATION. THE CONTROLLING MONUMENTS AND PROPERTY CORNERS SHOWN HEREON WERE LOCATED, STAKED AND CHECKED FROM A CLOSED FIELD TRAVERSE IN EXCESS OF 1:10,000 LINEAR CLOSURE AFTER AZIMUTH ADJUSTMENT.
  3. THIS SURVEY DOES NOT PURPORT TO SHOW ALL EASEMENTS OF RECORD OR OTHERWISE.
  4. THE BASIS OF BEARINGS FOR THIS SURVEY IS THE SAME AS THAT ESTABLISHED ON THE SURVEY FILED IN BOOK 26 OF SURVEYS, PAGES 176 AND 177, AND BOOK 33 OF SURVEYS, PAGE 36, RECORDS OF KITTITAS COUNTY, STATE OF WASHINGTON.

**EXISTING LEGAL DESCRIPTIONS:**

PARCEL 4 OF THAT CERTAIN SURVEY AS RECORDED ON AUGUST 29, 2001, IN BOOK 26 OF SURVEYS, AT PAGES 176 AND 177, UNDER AUDITOR'S FILE No. 200108290007, RECORDS OF KITTITAS COUNTY, STATE OF WASHINGTON.

PARCELS 5 AND 7 OF THAT CERTAIN SURVEY AS RECORDED ON AUGUST 29, 2001, IN BOOK 26 OF SURVEYS, AT PAGES 176 AND 177, UNDER AUDITOR'S FILE No. 200108290007, RECORDS OF KITTITAS COUNTY, STATE OF WASHINGTON.

PARCEL 6 OF THAT CERTAIN SURVEY AS RECORDED ON AUGUST 29, 2001, IN BOOK 26 OF SURVEYS, AT PAGES 176 AND 177, UNDER AUDITOR'S FILE No. 200108290007, RECORDS OF KITTITAS COUNTY, STATE OF WASHINGTON.

**LEGEND**

- SECTION CORNER
- QUARTER CORNER
- FOUND IRON ROD & CAP, LS 18092
- SET IRON ROD & CAP, LS 45503
- (R) RADIAL BEARING

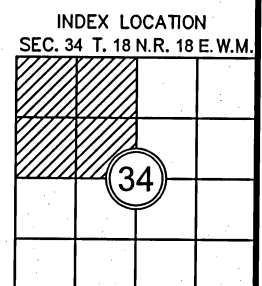
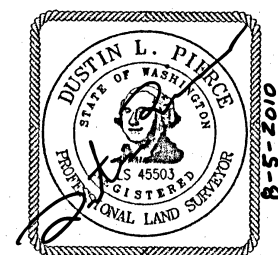

RECORDER'S CERTIFICATE 201008050037  
 FILED FOR RECORD THIS 5 DAY OF AUG 2010 AT 4:25 P  
 IN BOOK 37 OF Surveys AT PAGE 36 AT THE REQUEST OF  
DUSTIN L. PIERCE  
 SURVEYOR'S NAME  
JERALD V. PETTIT  
 County Auditor  
K. Leonard  
 Deputy County Auditor

SURVEYOR'S CERTIFICATE  
 THIS MAP CORRECTLY REPRESENTS A SURVEY MADE BY ME OR UNDER MY  
 DIRECTION IN CONFORMANCE WITH THE REQUIREMENTS OF THE SURVEY  
 RECORDING ACT AT THE REQUEST OF GARY JONES  
 IN AUG 2010  
Dustin L. Pierce  
 DUSTIN L. PIERCE  
 DATE 8-5-10  
 CERTIFICATE NO. 45503

**Encompass**  
 ENGINEERING & SURVEYING

Western Washington Division  
 165 NE Juniper Street, Suite 201 • Issaquah, WA 98027 • Phone: (425) 392-0250 • Fax: (425) 391-3055

Eastern Washington Division  
 108 East 2nd Street • Cle Elum, WA 98922 • Phone: (509) 674-7433 • Fax: (509) 674-7419

**BOUNDARY LINE ADJUSTMENT**  
 PREPARED FOR  
 GARY JONES  
 A PORTION OF THE NW 1/4 OF SECTION 34,  
 TOWNSHIP 18 NORTH, RANGE 18 EAST, W.M.

KITTITAS COUNTY	WASHINGTON
DWN BY <b>D. PIERCE</b>	DATE <b>8/2010</b>
CHKD BY <b>D. NELSON</b>	SCALE <b>1"=200'</b>
JOB NO. <b>10040</b>	SHEET <b>1 OF 1</b>